

5223 Wyoming Road

BETHESDA, MD 20816

\$799,500

Lower Level

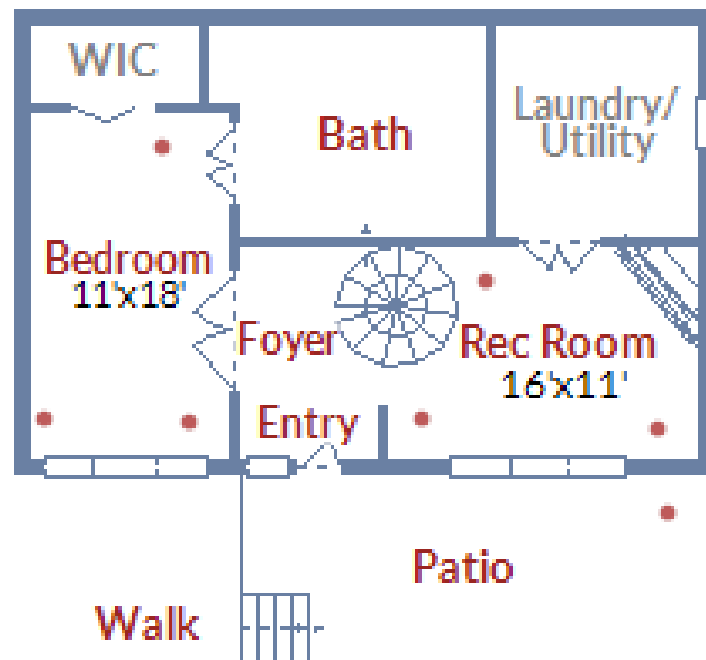

Copyright © TruPlace, Inc.



The charming rustic exterior belies a modern interior floor plan with an updated, open kitchen/dining/sitting area. Adjacent vaulted ceiling family room with high tech gas fireplace opens to the patio and natural back yard. Master Bedroom opens onto a fabulous upper deck and has a gorgeous new bathroom. Steps to Mohican Swim Club & more! Served by Whitman High School.

Property Details
4 Bedrooms
3 Bathrooms
Approx. 2,500 sq. ft. of finished living area

Lot size: 7,904 square feet (.18 ac)
Real property tax and other non-tax charges that a new owner will expect to pay in the first full fiscal year of ownership are estimated to be \$8,568.19

ROBERT JENETS

Cell: 301-257-3200

Stuart & Maury, Inc. Realtors

Email:
Robert@robertjenets.com



All information deemed reliable, not guaranteed.

ROBERT JENETS

Stuart & Maury, Inc. Realtors
4833 Bethesda Avenue #200
Bethesda, MD 20814

Cell: 301-257-3200

Robert@robertjenets.com
More information and photos may be found at: www.robertjenets.com.



Celebrating Our
60th
1956-2016
YEAR SERVING THE COMMUNITY

DESCRIPTION:

Glen Echo Heights is a “woody” neighborhood of winding streets known for its **diversity of architectural styles**. Every home is unique, yet, there is an overall feeling of cohesive individuality that defines the personality of this **highly desirable community**. With a prime location along the Potomac River, between Massachusetts Avenue and MacArthur Boulevard, this area of Bethesda is **convenient to Washington, D.C.**, Northern Virginia, and Montgomery County, MD. The Potomac River, C&O canal, historic **Glen Echo Park**, the Mohican Swim club, and the Sycamore Island Canoe club are all close by. The public schools that currently serve this area are **Wood Acres Elementary, Thomas Pyle Middle, and Walt Whitman High School**. Also close by is the popular **Crescent Trail** which is treasured by the many people who use it daily for **hiking and biking** into thriving downtown Bethesda or in the other direction all the way to Georgetown.

Sometimes referred to as a “modern treehouse” this whimsical home has been thoughtfully updated and renovated to produce the open floor plan beauty that you see here.

- ◆ 4 Bedrooms, 3 Baths, (3 and 2 main, 1 and 1 below)
- ◆ Granite kitchen open to the other living spaces—nice!
- ◆ Cathedral ceiling Family Room with trendy gas Fpl.
- ◆ Gorgeous new Master Bath, Updated Hall Bath
- ◆ Nearly new roof
- ◆ Double pane windows for energy efficiency
- ◆ Hardwood flooring throughout—beautiful!
- ◆ Fabulous upper Deck overlooks treed view
- ◆ Rear patio for the barbeque, lush natural rear garden
- ◆ Cool spiral staircase between levels
- ◆ Walt Whitman High School



Kitchen and Dining area



Cathedral ceiling Family Room off the Kitchen



Master Bath



Lower Level daylight Rec Room w/ FPL

Main Level

