

7309 Broxburn Court

BETHESDA, MD 20817

\$1,498,000

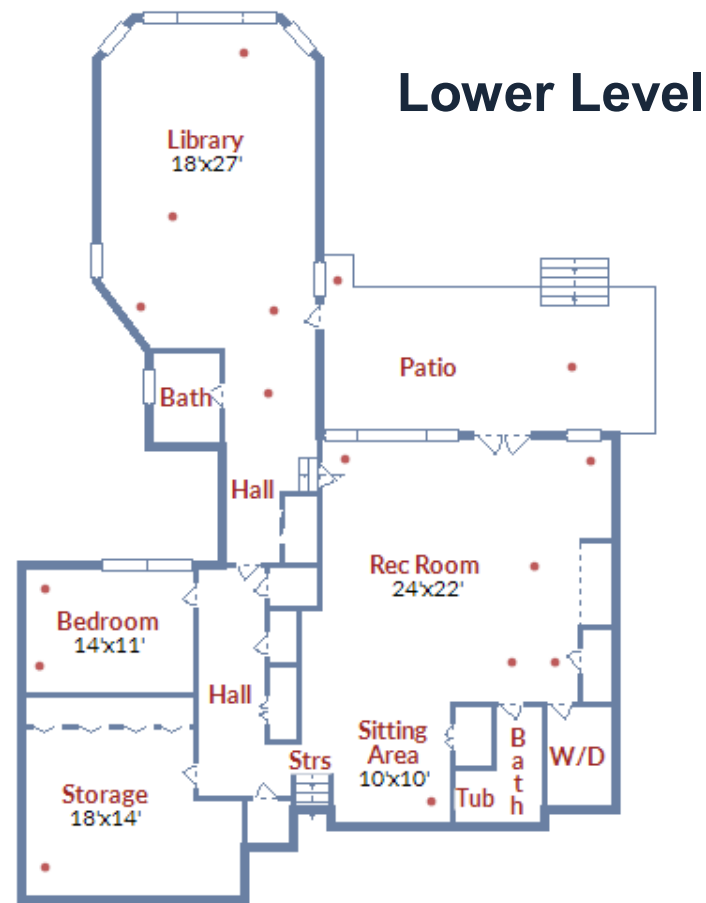

Exciting contemporary home on a half acre cul-de-sac lot in prestigious Bannockburn Estates. Bright, airy, expansive living space with gracious rooms flooded with light from huge windows! Master Suite views of wooded splendor. Huge chef's kitchen w/breakfast bar. Enormous walk-out lower level rooms. Served by Whitman High School.

Property Details
4 Bedrooms
5.5 Bathrooms
Approx. 5,500 sq. ft. of finished living area

Lot size: 24,528 square feet (.56 ac)
Real property tax and other non-tax charges that a new owner will expect to pay in the first full fiscal year of ownership are estimated to be \$12,307.11

ROBERT JENETS

Cell: 301-257-3200

Stuart & Maury,
Inc. Realtors

Email:
Robert@robertjenets.com



All information deemed reliable,
not guaranteed.

ROBERT JENETS

Stuart & Maury, Inc. Realtors
4833 Bethesda Avenue #200
Bethesda, MD 20814

Office: 301-654-3200
Cell: 301-257-3200

Robert@robertjenets.com
More information and photos may be
found at: www.robertjenets.com.



Celebrating Our
60th
1956-2016
YEAR SERVING
THE COMMUNITY

DESCRIPTION:

This exciting home was extensively renovated and expanded in 2007 when the Owner's Suite wing was added with the Library and extra full Bath below. Here are some Detail Points of interest:

- ◆ Fabulous Kitchen with abundant light wood cabinetry Dacor 6-burner Stove, Wall Oven, Microwave, Warming Drawer
- ◆ Open Living areas with 10' pine ceilings, huge windows and hardwood flooring
- ◆ Remarkable Owner's Suite with breathtaking wooded views
- ◆ 3 main level Bedrooms with en-suite baths
- ◆ Large lower level Library with the same awesome views as the Owner's Suite above
- ◆ 4th Bedroom and Full Bath on lower level
- ◆ Convenient access to I-495 and I-270
- ◆ Short commute to DC and Northern VA



Kitchen and Sitting area



Library / Multi-purpose Room



Master Bath



Family Room open to Dining Room



Family Room with Wood Stove

Main Level

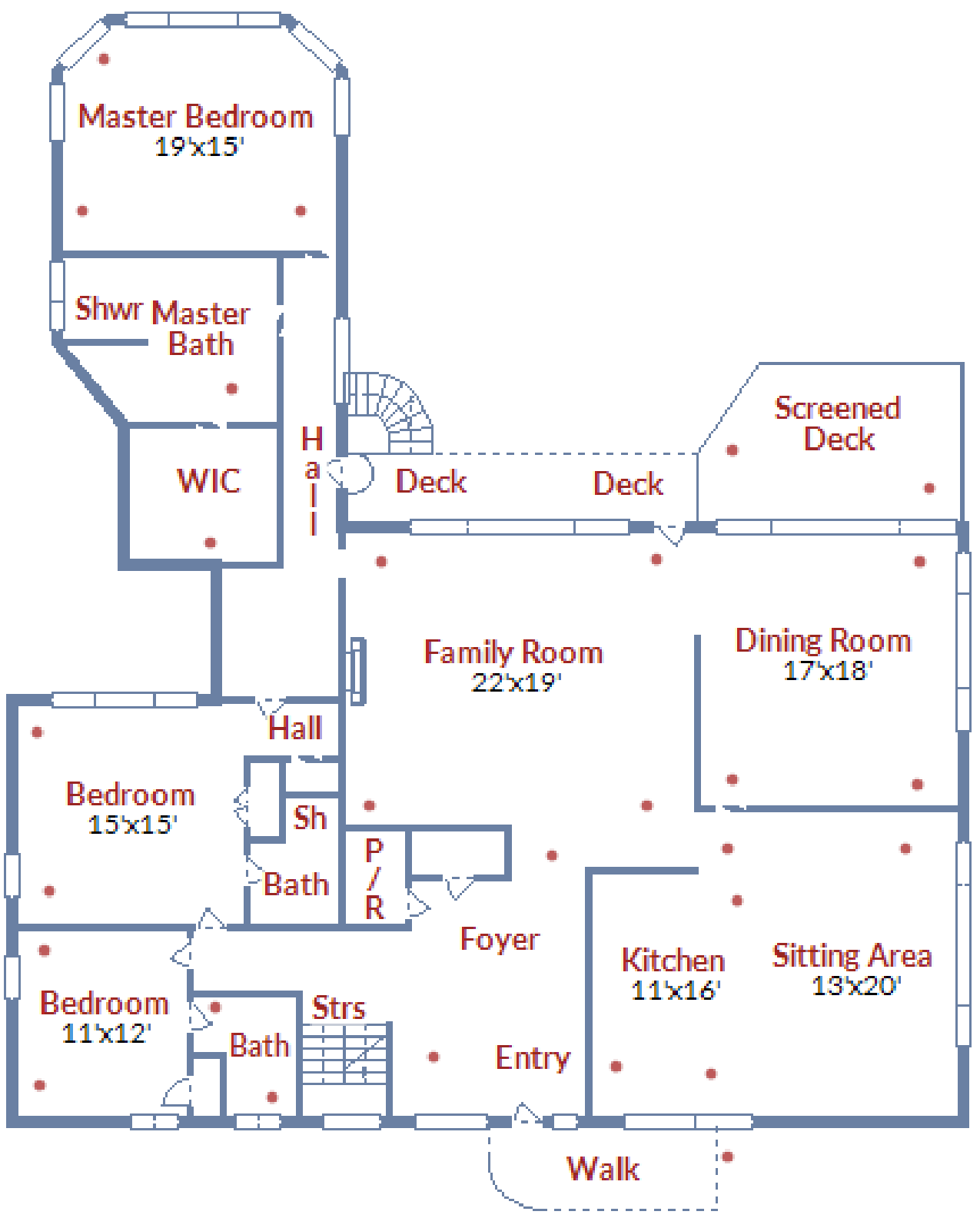

Copyright © TruPlace, Inc.