

DATE	SUBMISSION
6/21/23	PERMIT SET
DATE	REVISIONS

STUDIO Z DESIGN CONCEPTS, LLC
 800 WOODMONT AVENUE SUITE 200
 BETHESDA, MARYLAND 20814
 PHONE: 301-361-4391 FAX: 301-361-1910



PRIVATE RESIDENCE
 9309 ROCKHOLLY STREET
 BETHESDA, MD 20814

Professional Certification
 I hereby certify that these documents were prepared or approved by me, and that I am a duly licensed architect under the laws of the State of Maryland License Number: 0274 Exp. Date: 08/28/2023



A102

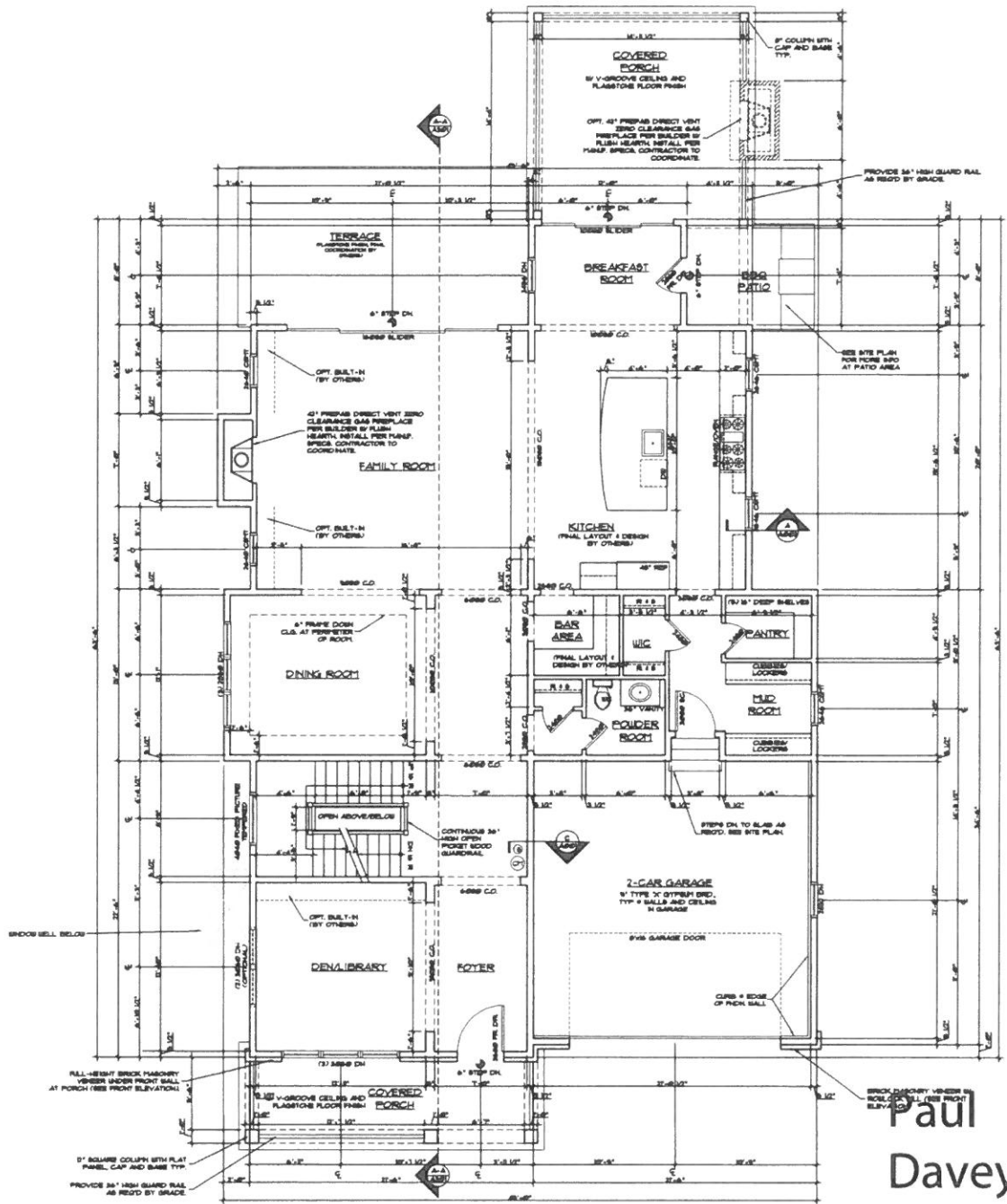

NOTE: ALIGN TOPS OF WINDOWS, BULKHEADS AND CASED OPENINGS TO R.O. OF INTERIOR DOORS, U.O.N.

FIRST FLOOR PLAN
 SCALE = 1/4" = 1'-0"
 1/3200 FIN. SF

ROUND BATTIS R-5/8 FIN. AT ALL BATHROOM, LAUNDRY ROOM, AT RECREATIONAL CHAMBERS AND SECOND FLOOR DECK BELOW ALL BATHROOMS AND LAUNDRY ROOMS.

FLOOR MATERIAL BREAK

Digitally signed by Paul Davey
 Date: 2023.06.23 12:49:26 -04'00

DATE	SUBMISSION
6/2/23	PERMIT SET
DATE	REVISIONS

STUDIO Z DESIGN CONCEPTS, LLC
 800 WOODMONT AVENUE SUITE 900
 BETHESDA, MARYLAND 20814
 PHONE: 301-951-4331 FAX: 301-951-1815



PRIVATE RESIDENCE
 9309 MCKINLEY STREET
 BETHESDA, MD 20814

Professional Certification
 I hereby certify that these documents were prepared or approved by me, and that I am a duly licensed architect under the laws of the State of Maryland License Number: 52714 Exp. Date: 12/28/2023

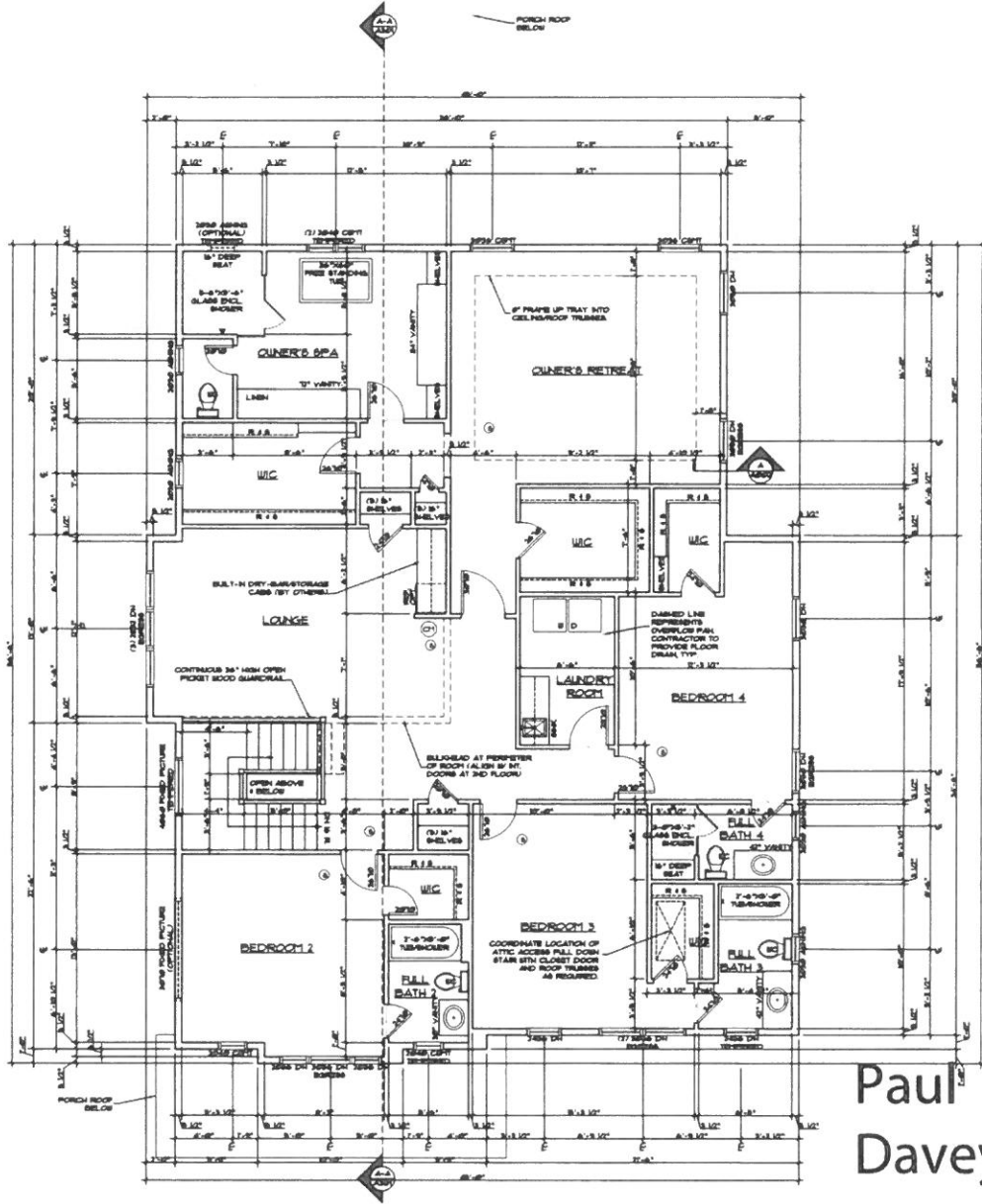

NOTE: ALIGN TOPS OF WINDOWS, BULKHEADS AND CASED OPENINGS TO R.O. OF INTERIOR DOORS, U.O.N.

SECOND FLOOR PLAN
 SCALE = 1/4" = 1'-0"
 2212 FIN. OF

SOUND BATHS, R-5/8 FIN. AT ALL BATHROOM, LAUNDRY ROOM, AT MECHANICAL CHAMBERS AND SECOND FLOOR DECK BELOW ALL BATHROOMS AND LAUNDRY ROOMS.

FLOOR MATERIAL BREAK

Digitally signed by Paul Davey
 Date: 2023.06.23 12:50:22 -0400

A103

DATE	SUBMISSION
6/2/23	PERMIT SET
DATE	REVISIONS

STUDIO Z DESIGN CONCEPTS, LLC
 800 WOODMONT AVENUE SUITE 900
 BETHESDA, MARYLAND 20814
 PHONE: 301-901-4391 FAX: 301-901-1913



PRIVATE RESIDENCE
 9309 MCKINLEY STREET
 BETHESDA, MD 20814

Professional Certification
 I hereby certify that these documents were prepared or approved by me, and that I am a duly licensed architect under the laws of the State of Maryland License Number: 02714 Exp. Date: 02/28/2023



A101

LOWER LEVEL FLOOR PLAN

SCALE = 1/4" = 1'-0"
 395 FIN. SF
 (+350 SF OPT. EXERCISE ROOM)

ROUND BATHS, R-SUB MH AT ALL BATHROOM, LAUNDRY ROOM, AT MECHANICAL CHAMBERS AND SECOND FLOOR DECK BELOW ALL BATHROOMS AND LAUNDRY ROOMS

FLOOR MATERIAL BREAK

REVERSE LEDGE

NOTE: ALIGN TOPS OF WINDOWS, BULKHEADS AND CASING OPENINGS TO R.O. OF INTERIOR DOORS, U.O.N.

EXPRESS WINDOW SILL AS REQUIRED BY GRADE. CONTRACTOR TO COORDINATE WITH WINDOW SIZES SELECTED. FINISH AND PAINT INTERIOR WALLS OF SILL.

10" CONCRETE FOUNDATION WALL W/ 4" REBAR AND 4" HORIZONTAL LEDGE 6"X REBAR = 20" O.C. SEE PLAN HATCHING AT LONG DIMENSIONAL = FOOTINGS U.O.N.

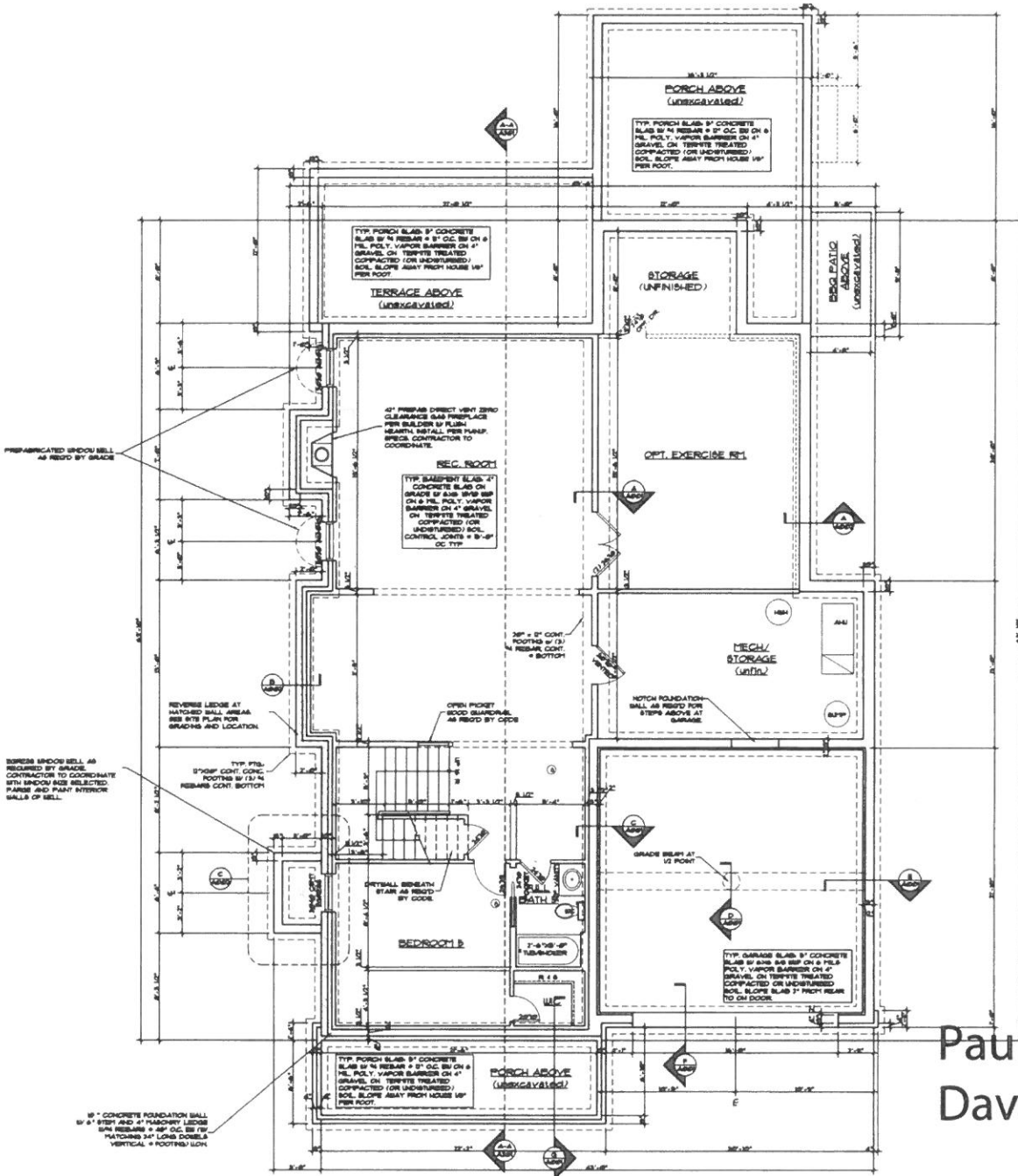

Paul Davey
 Digitally signed by Paul Davey
 Date: 2023.06.23 12:48:40 -04'00'